

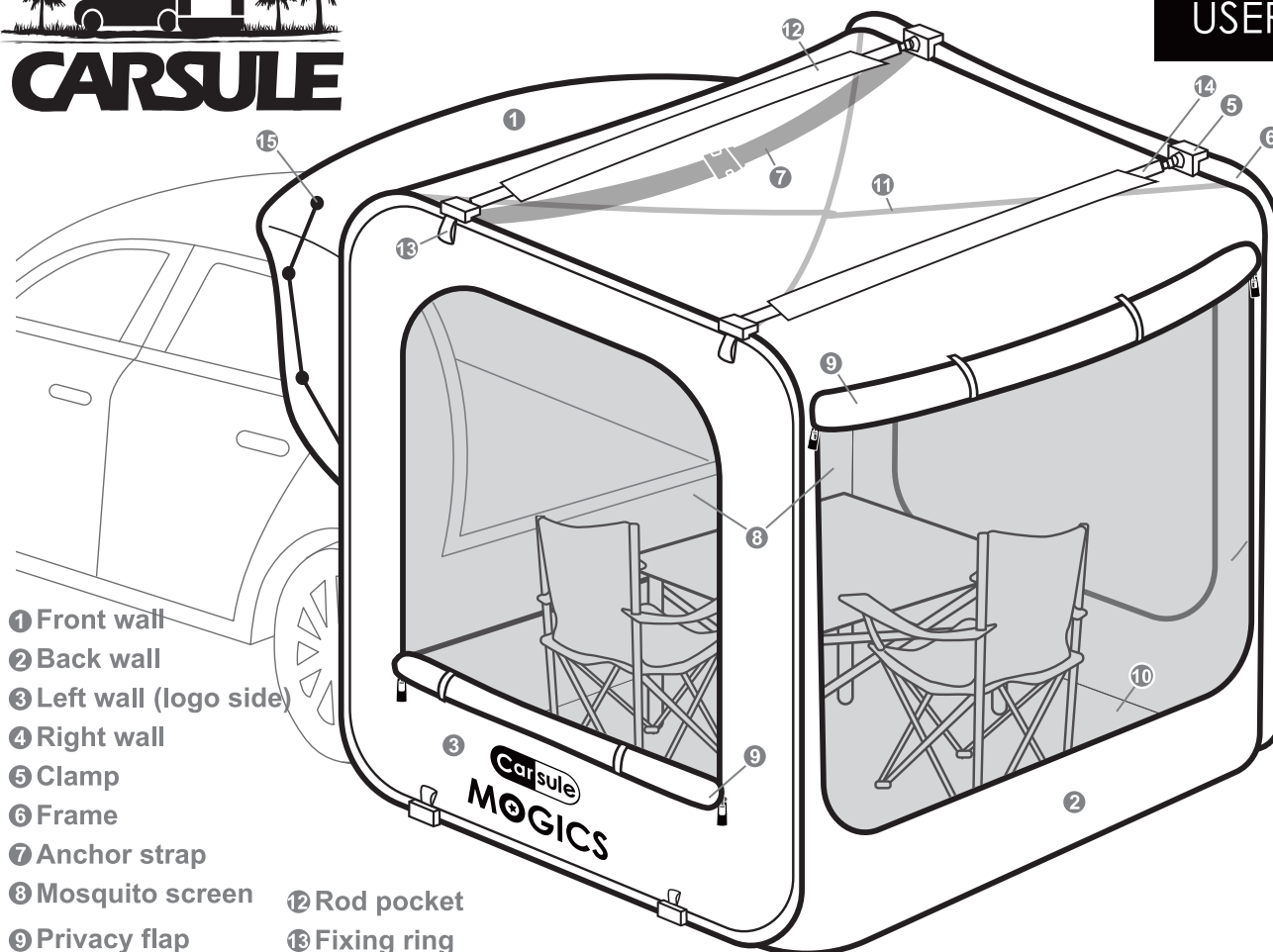

MOGICS

USER MANUAL



- ① Front wall
- ② Back wall
- ③ Left wall (logo side)
- ④ Right wall
- ⑤ Clamp
- ⑥ Frame
- ⑦ Anchor strap
- ⑧ Mosquito screen
- ⑨ Privacy flap
- ⑩ Felt rug
- ⑪ Tension rope
- ⑫ Rod pocket
- ⑬ Fixing ring
- ⑭ Rod
- ⑮ Magnet cord



* Vehicle, table and chairs are NOT included *

Parts Diagram

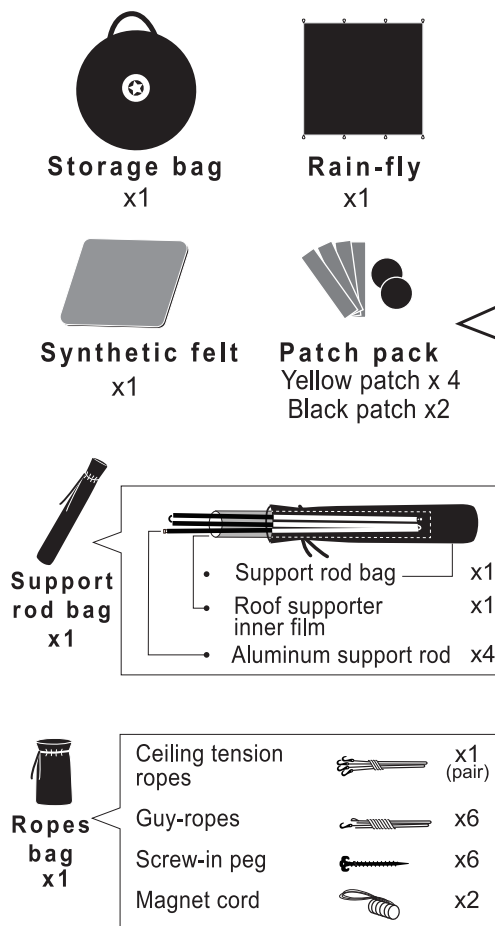

Patch Instruction

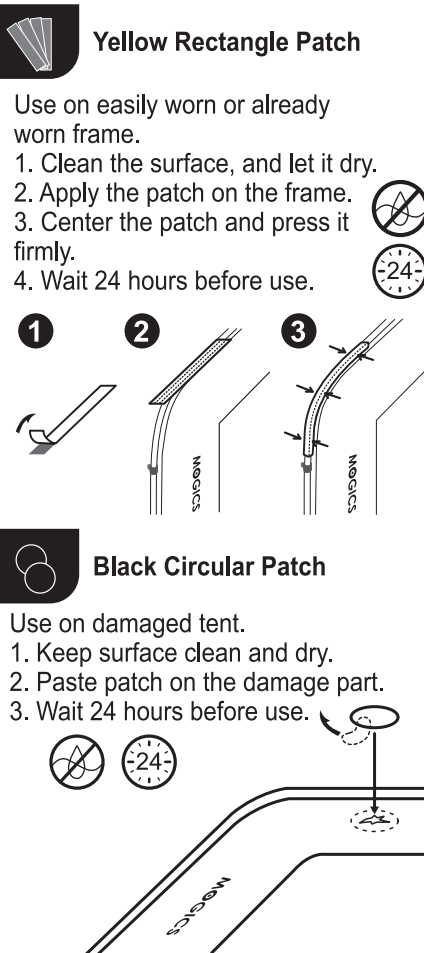

Assemble Preparation

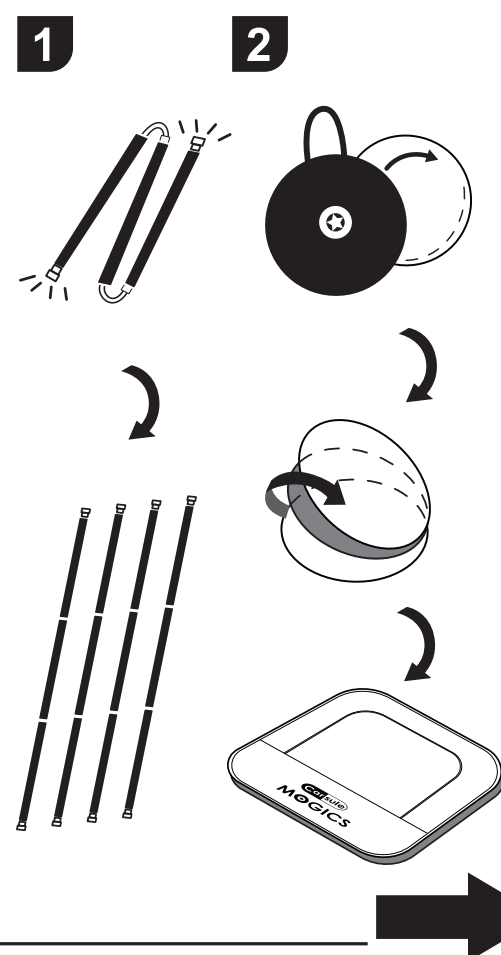



- 1** Lay the tent flat with the logo facing up, and unzip the front and rear doors to extend the tent

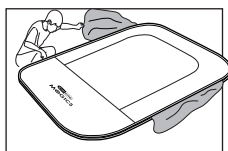

※Un-zip the front & rear door

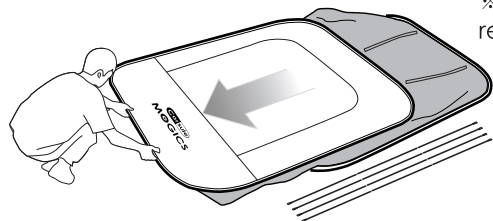

- 5** Put the bottom of the aluminum rod behind the fastener and fix it like the drawing

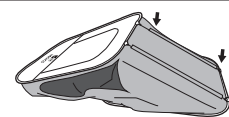

On the other side, fix the aluminum rod according to step 4.5

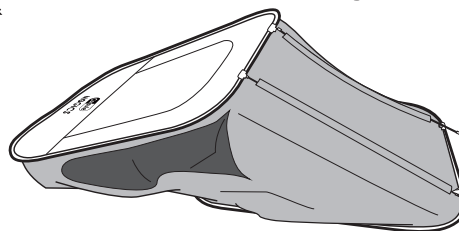

⚠ Don't buckle

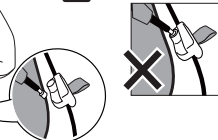

- 2** Lift the tent and insert the pole

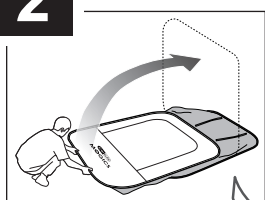

⚠ Don't buckle

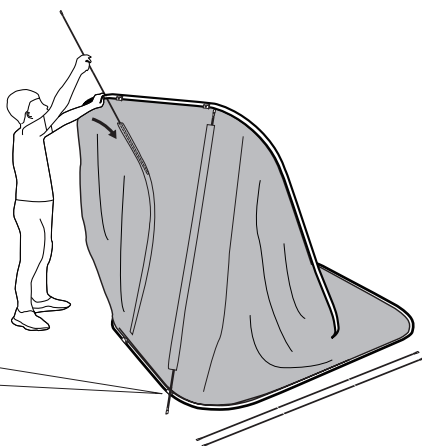
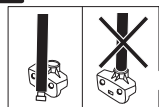

- 6** Hold the frame to stand up the tent, and then pull the bottom into a square

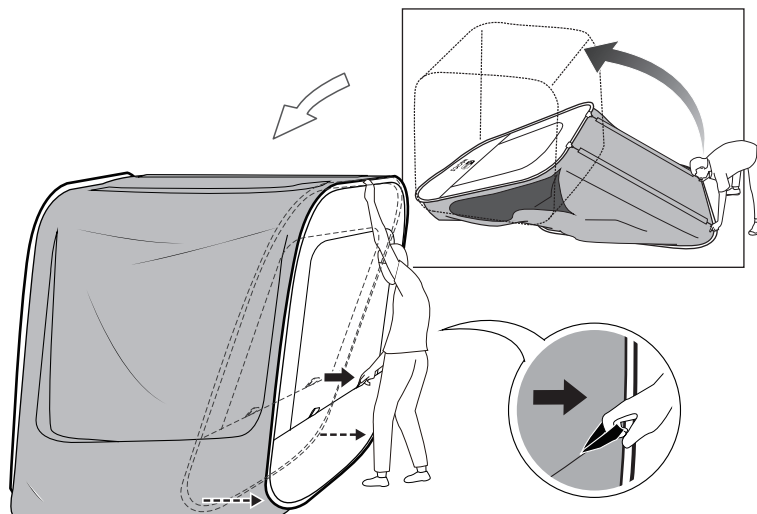

- 3** Hold the aluminum pole and put down the tent

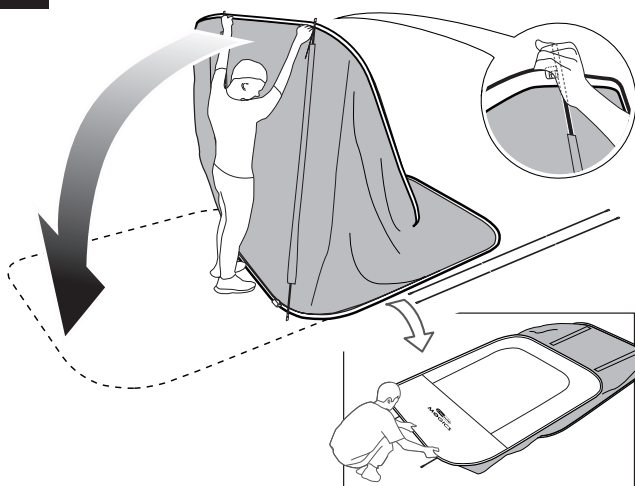

- 7** Close both sides windows

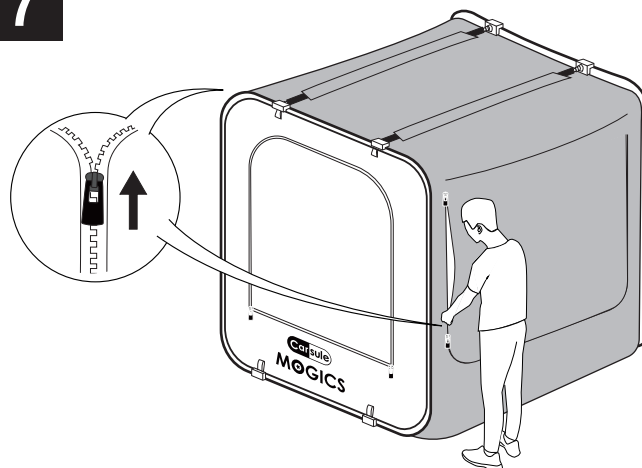

- 4** After inserting the upper two aluminum poles, lift the middle of the tent and buckle the poles

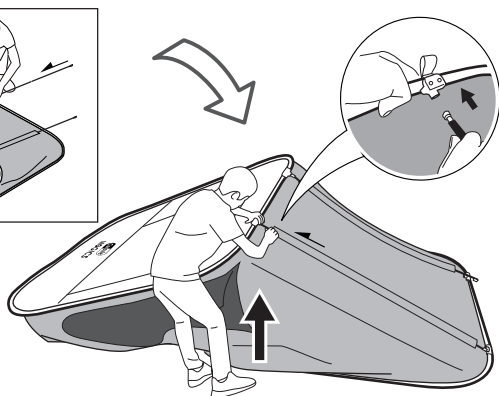
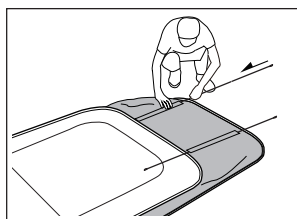

- 8** Fix #1~#6 fasteners

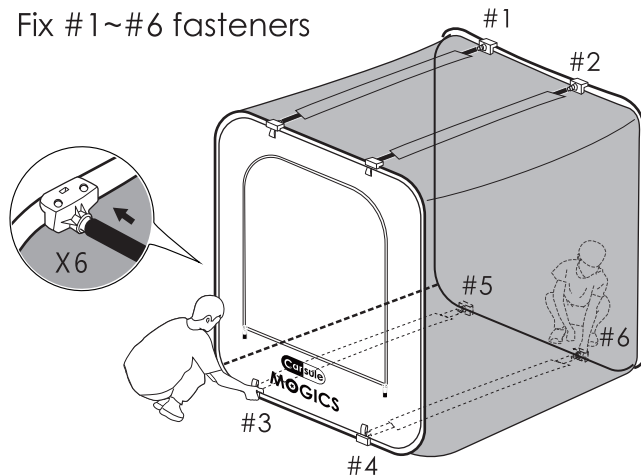

Attach to Vehicle

Instruction
Video



- 1** Open the rear car door. And lift the front door of the tent upwards.

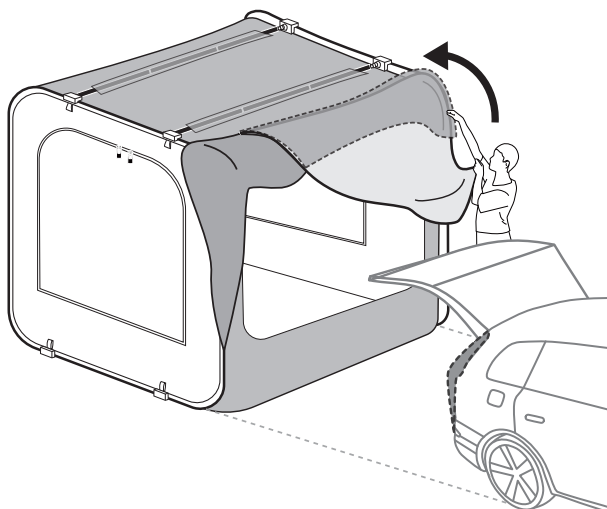

- 2** Lift tent from the front and move it close to the rear bumper.

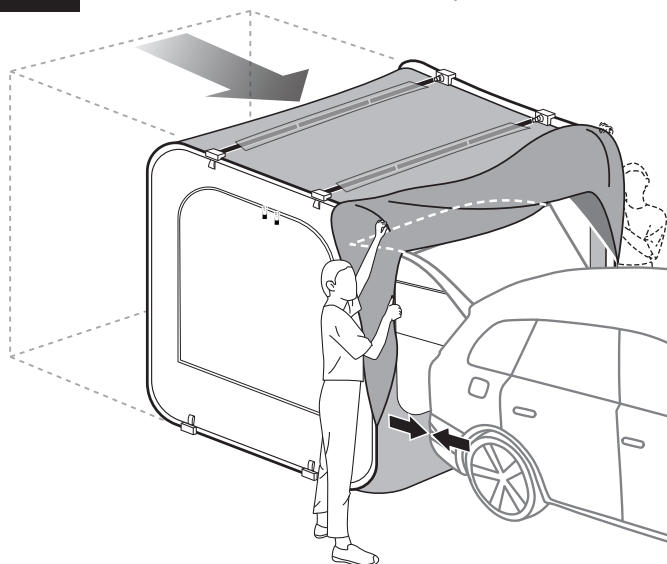

- 3** Buckle the anchor strap

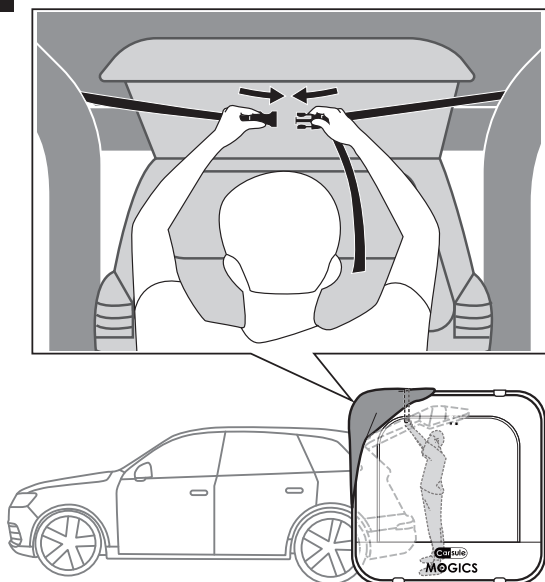

- 4** Hang the tension rope
Cross two ropes to make it tighter.

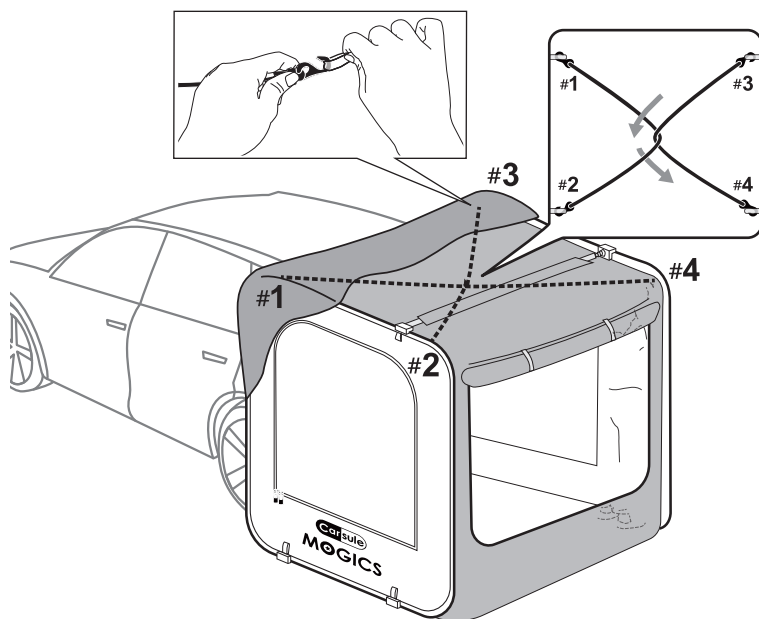

- 5** spread out the front flap to cover the trunk lid.

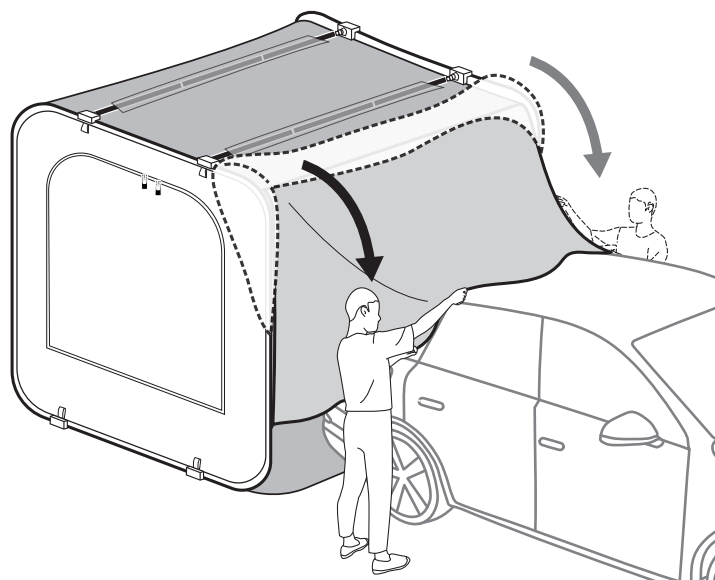

- 6** Fold the surplus flap down And fix it on the roof and both sides of the car with the magnets

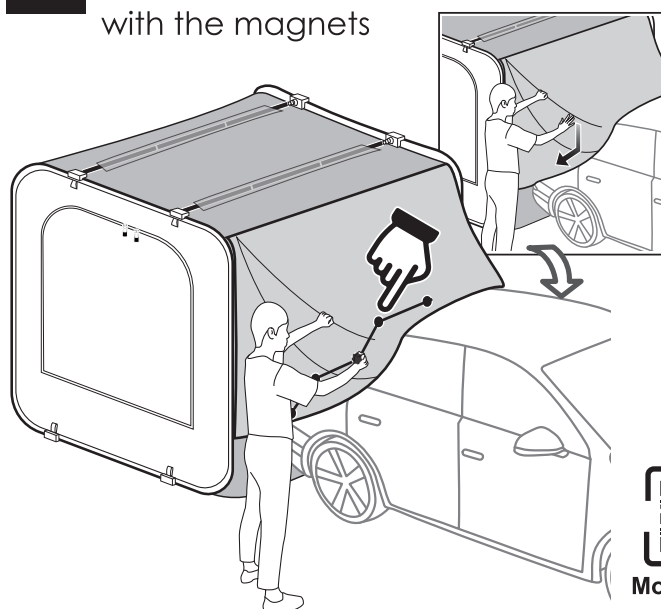

More Detail

Stand Alone Usage (Tension Rope Guy-Rope)

Please set up the guy-ropes when Carsule is set standing alone. It is not advised to use Carsule independently in strong wind.

Instruction Video



1 Hang the tension ropes.

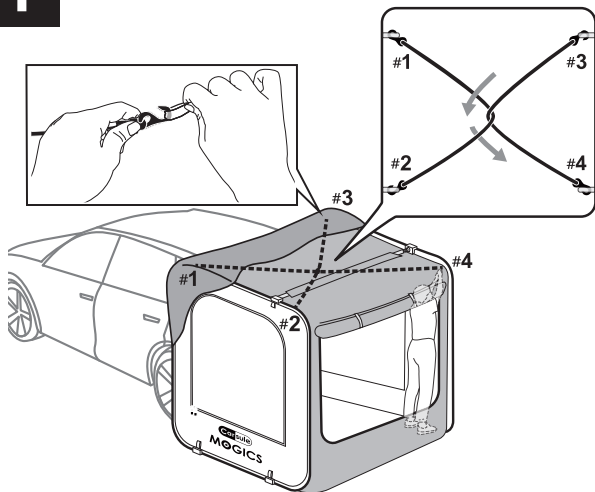

2 Place the peg at 45 degrees to the ground, and swirl it downward into the ground.

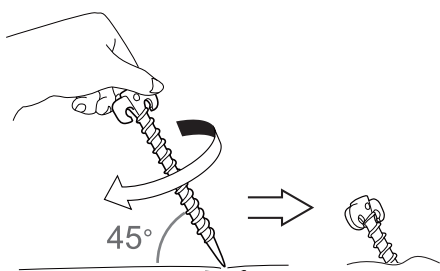

3 Fix the guy-ropes on the fixing ring, and adjust the ropes to tie the pegs.

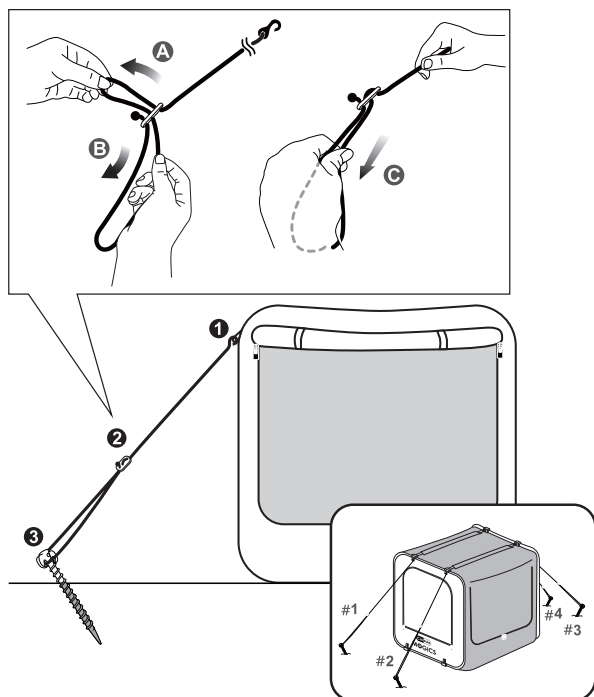

Roof Supporter & Rain-Fly



Be sure to set up the roof supporter and rain-fly when raining.

Instruction Video



1

Insert the roof support.

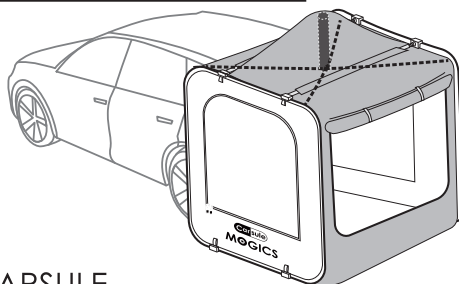

2

Cover CARSULE with the rain-fly.

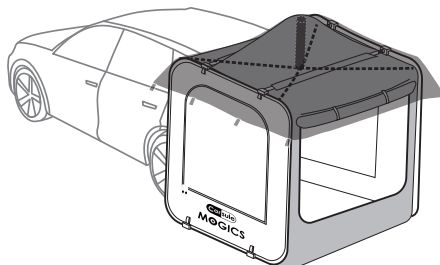

Advised Position

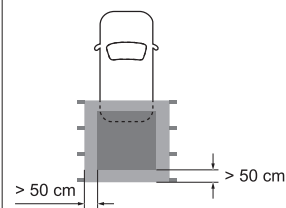

3

Fasten the corner guy-ropes.

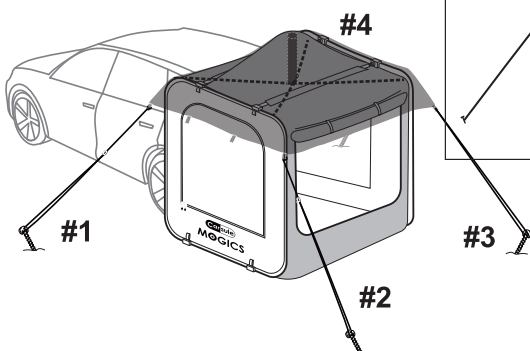

Side View

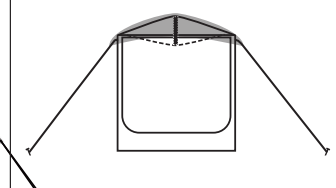

4

Fasten the middle guy-ropes.

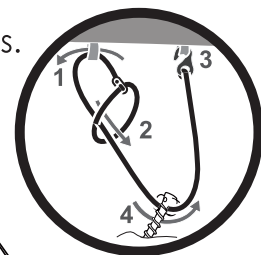
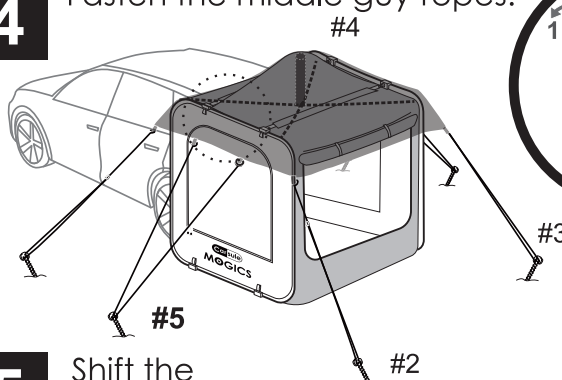

5

Shift the four corner

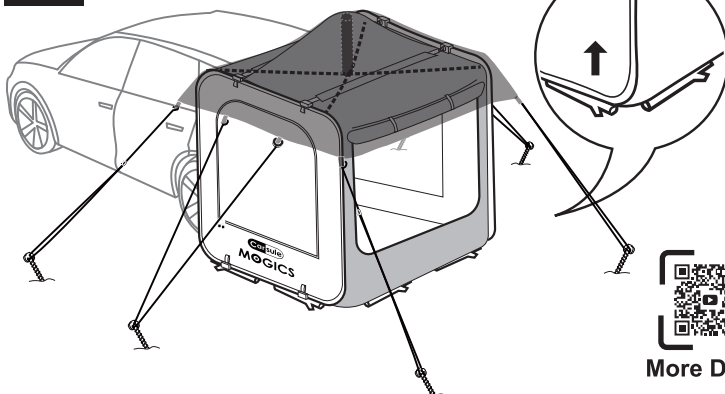

More Detail

Disassembly Preparation



Unlock the anchor strap



Close the trunk



Untie the tension ropes



Fold the felt rug



Unfasten the guy-ropes



Collect the magnet cord



Remove the pegs

Fold the Carsule

Instruction Video ▶



1 First unlock #1 #2 #3 #4 fasteners

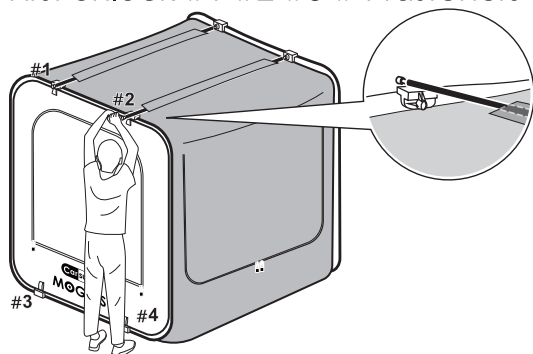

2 Unfasten the #5 #6 #7 #8 fasteners and take out 4 aluminum rods

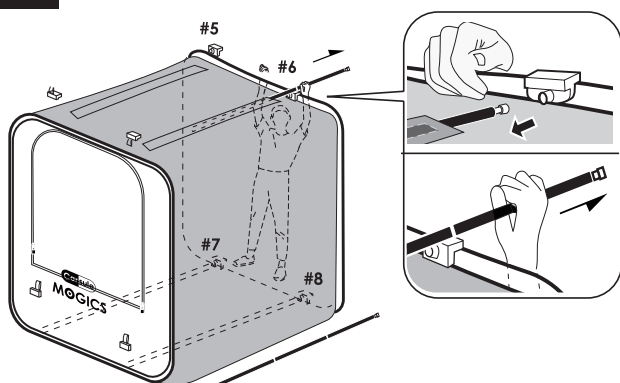

3 Unzip the zipper to release the air inside the tent

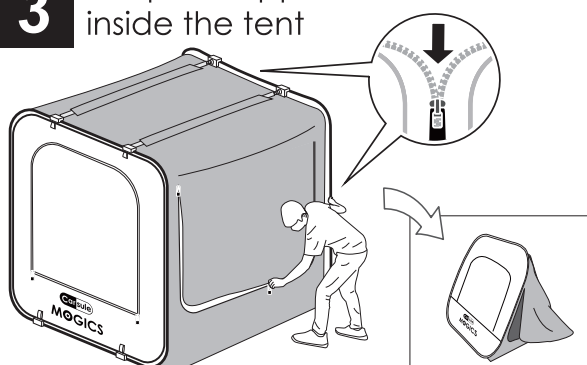

4 Hold the lower edge of both ends of the frame and lift them up slightly, And fold them inwards and place it flat on the ground.

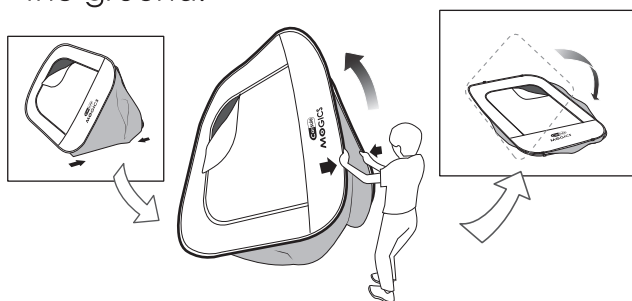

5 Tuck the protruding cloth inwards neatly, Close the window zips.

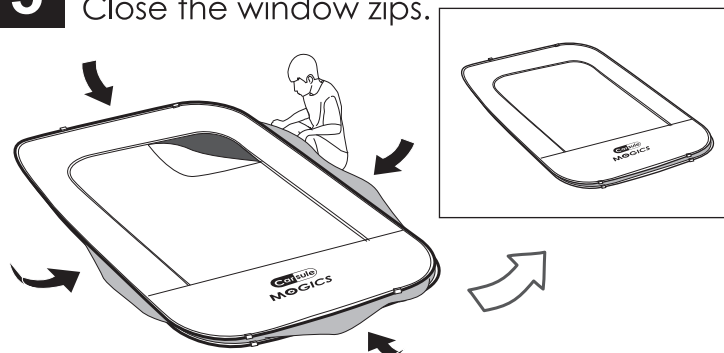

6 Lift up the bottom, and use the folded rod to thrust the bottom flap inward.

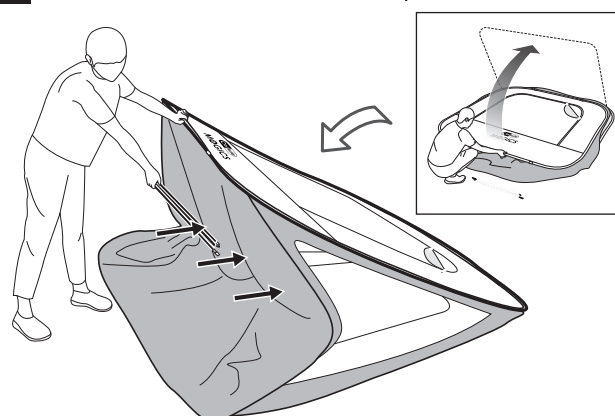

7 Hold the corner of the tent Fold tent in half diagonally

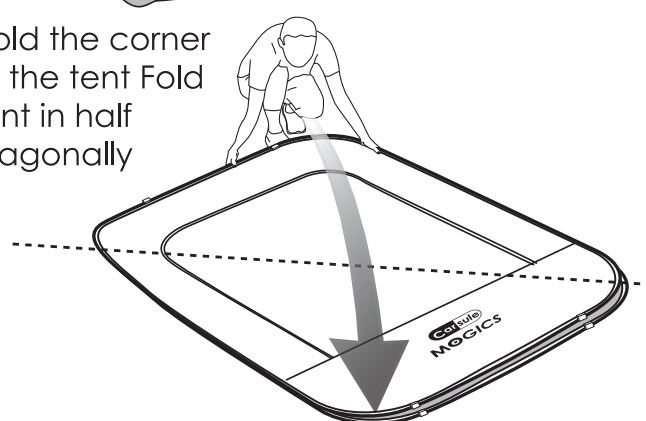

8 Remaining in contact, move your hands back along the frames

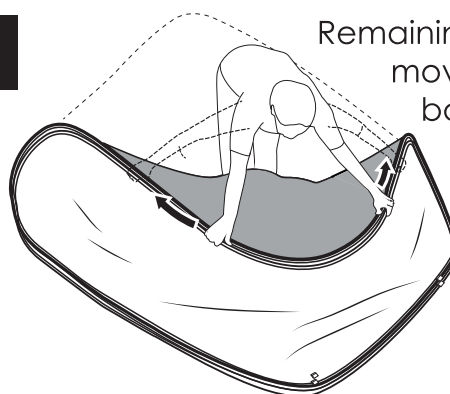

9

Bring your hands together to fold the sides

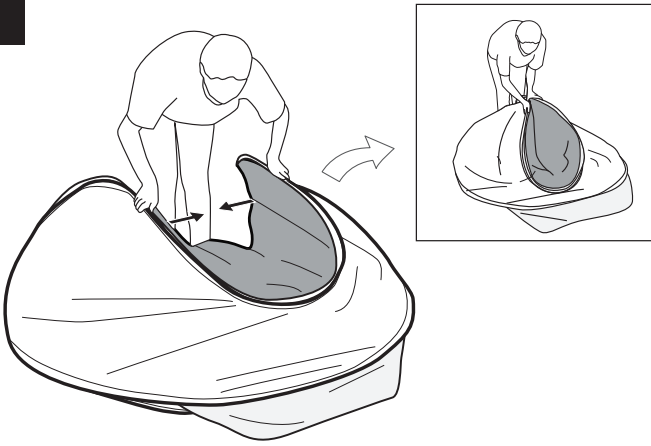

10

Tuck the middle circle inward and press it down

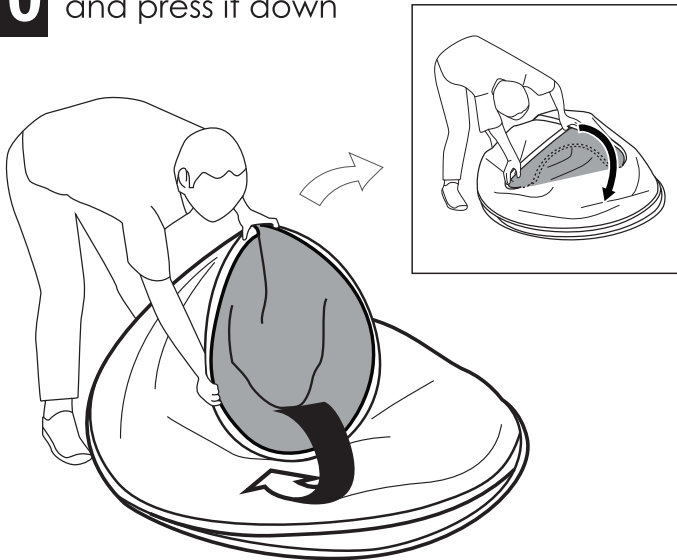

11

First press frame A to the middle, Then press frame B to the middle

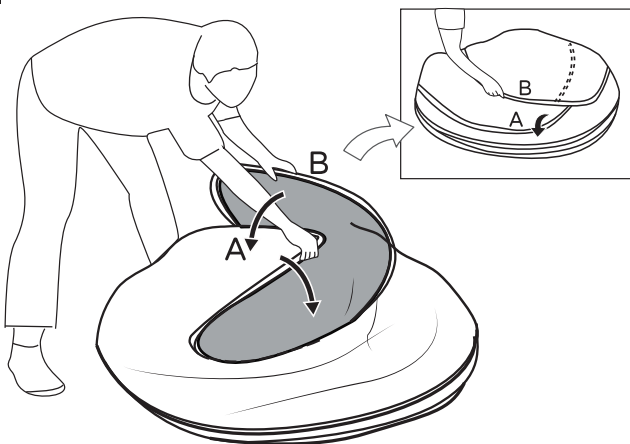

12

Twist and adjust the frame to get circles of the same size

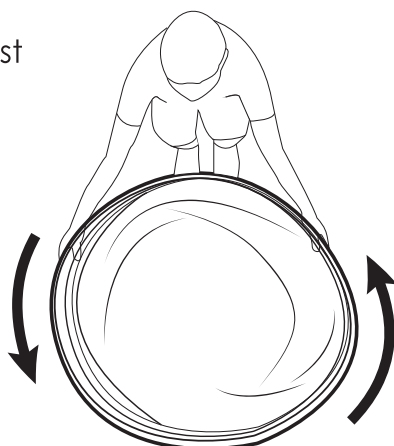

13

Squeeze out the air from the tent

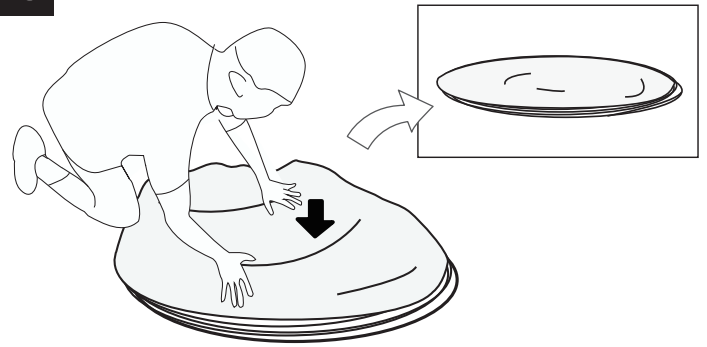

14

Put the tent in the bag and further squeeze out the air in the storage bag

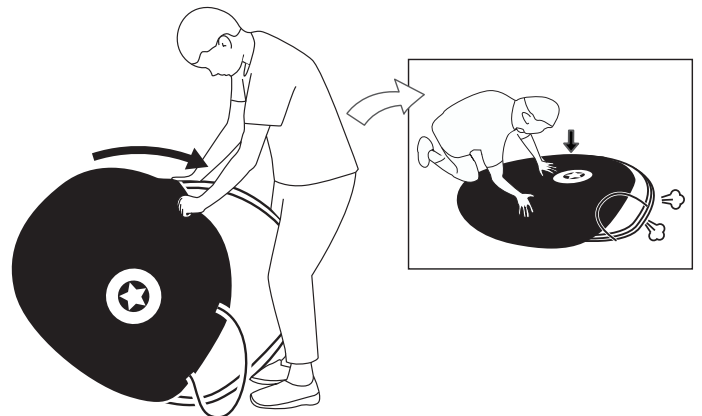

15

Lift the storage bag and hit it on ground repeatedly to ease the full insertion of the tent in the bag.

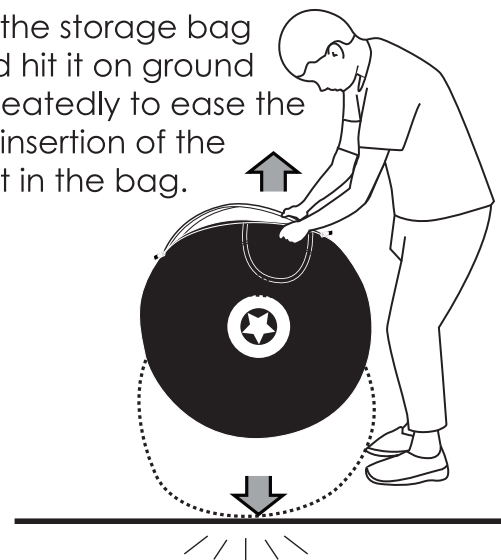

16

With one hand, press the tent into the storage bag, and with another, zip up to complete the tent storage.

